

PRESSURE RELIEF VALVE

The safety valve is the last safety net when abnormal pressure conditions threaten the silo construction. That is why sudden positive or negative pressure in the silo must be treated immediately. Although it would be ideal that the safety valve never active it needs to be effective and reliable if by chance it was needed.

With more than 60.000 units installed worldwide, this safety valve has proven to be fully operational under many different conditions.

Inductive scanners (accessories)

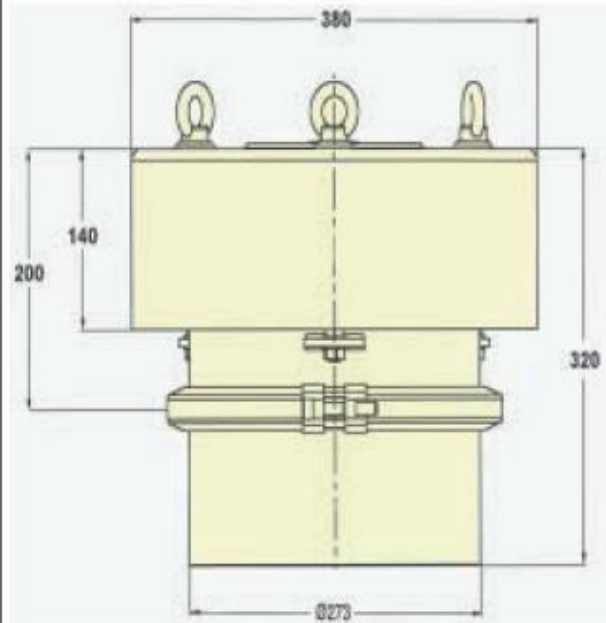
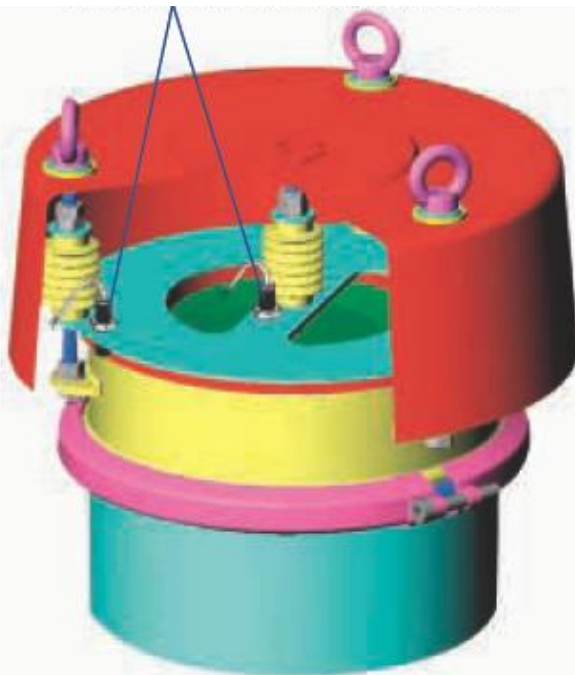

Description

The safety valve consists of a cylindrical house mounted on a welded pipe branch with a hose clamp, a disc shaped inner steel lid for vacuum held in position by a central spring, an external steel ring for gauge/over pressure held in position of three springs, gaskets and weather protection cover.

Function

In the safety valve the springs keeps the lids closed when the pressure is within the prior set areas. The three outer springs holds the ring-shaped lid closed as long as the power generated by the pressure inside the silo doesn't overcome the spring power. As soon as the pressure exceed the prior set pressure the lid will get lifted and the pressure will equalize. The small lid covers a central circular opening in the big lid from below. It is being held by one spring and is being pushed towards the big lid by the normal pressure inside the silo. In case that a vacuum occurs, the spring will get pressed together and the lid will open. Then the air will get into the silo and the vacuum will equalize.



K.S.M. Kragelund ApS

Bøgballevej 19 • 8723 Løsning

Tlf. + 45 76 75 89 50

E-mail: info@kolsters.dk • www.kolsters.dk



Service/output & Technical details – Benefits/Advantage

- House in normal steel painted in RAL 7001 or 304 / 316 stainless steel house.
- Weather protection cover in stainless steel.
- House diameter = 273mm (10 in).
- Air volume up to 9,000m³/h (5,300 cfm).
- Prepared for installation of inductive sensors.
- Both versions preset to maximum negative pressure of - 0.005 bar and maximum overpressure of + 0.05 bar.
- If the customer's requirements are different, the valve can be adjusted to a negative pressure from - 0.003 bar to - 0.013 bar and for overpressure +0.02 bar to + 0.1 bar.
- Weight: 9.5 kg.
- High resistance to atmospheric preparations.
- Easy to install.
- Fast maintenance.

Options & accessories

- Flanged connection..
- ATEX-certified version for zone 21.
- Inductive scanners.



Technical Data - Technische Daten - Données techniques - Dati tecnici

	Size 273 Größe 273 Taille 273 Taglia 273 mm	Size 375 Größe 375 Taille 375 Taglia 375 mm
A	400	525
B	356	468
C	125	175
D	120	120
E	325	400
Ø F	273	356
kg	9.5	23

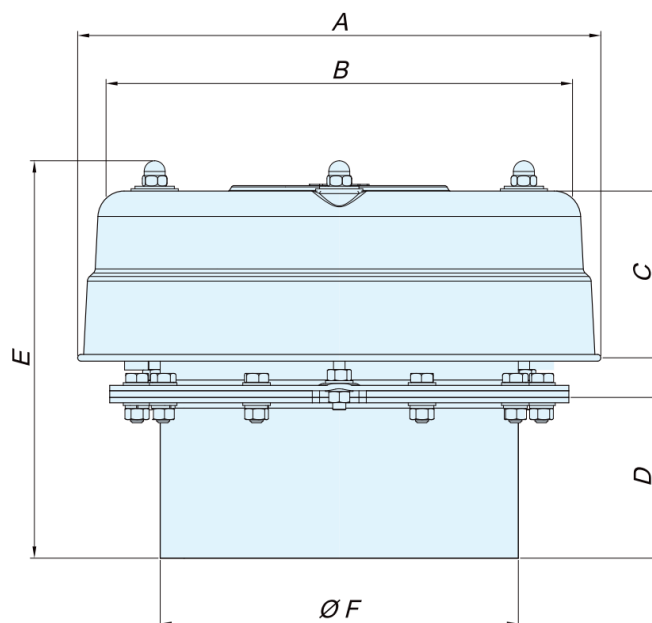

* Calibrated by Manufacturer:

* Werkseitig tarierter auf:

* Calibrée par le constructeur à:

* Tarata dal costruttore a:

-50 mm H₂O
500 mm H₂O

1 = Carbon steel

1 = Normalstahlausführung

1 = Acier au carbone

1 = Acciaio al carbonio

2 = 304 st.st.

2 = Edelstahl 1.4301

2 = INOX 304

2 = AISI 304



K.S.M. Kragelund ApS

Bøgballevej 19 • 8723 Løsning

Tlf. + 45 76 75 89 50

E-mail: info@kolsters.dk • www.kolsters.dk

